

Flat End Movable Handle

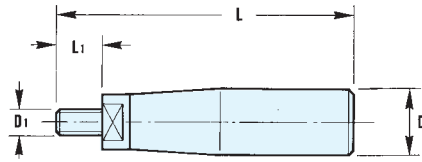

NEW



THREAD

Flat End Movable Handle

- Handle is foggy plating treated.
- Detachable nut is blackened.
- Fit to common movable handwheel.
- Ready to use.
- Good handing.

ORDER NO.	D ₁	D	L ₁	L	CODE NO.
VFE-10	M10x1.5P	23	16	100	7003-001
VFE-83	3/8"x16	22	16	99	7003-002
VFE-8	M8x1.25P	19	16	93	7003-003
VFE-165	5/16"x18	19	10	78	7003-004

Ellipse Movable Handle

NEW

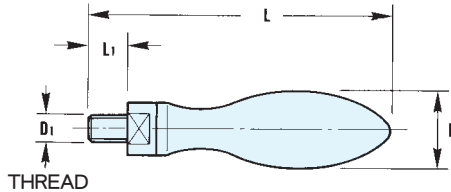

THREAD

Ellipse Movable Handle

- Brilliant or foggy plating surface.
- Fit to common movable handwheel.
- Easy to install
- Shine and good looking.

ORDER NO.	D ₁	D	L ₁	L	CODE NO.
VEM-10	M10x1.5P	26	13	110	7003-007
VEM-83	3/8"x16	25	13	99	7003-008
VEM-8	M8x1.25P	20	9	80	7003-009
VEM-6	M6x1.0P	16	7	60	7003-010

Ball Knobs

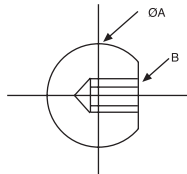

Name	Material	Surfaced process
Knob	Bakelite (KU)	Black

mm

ORDER NO. (KU)	A	B	CODE NO.
VKB-6AA	25	M6 x 1.0P	7003-120A
VKB-8A	25	M8 x 1.25P	7003-121A
VKB-8BA	38	M8 x 1.25P	7003-123A
VKB-10A	38	M10 x 1.5P	7003-124A
VKB-12AA	38	M12 x 1.75P	7003-127A
VKB-12BA	42	M12 x 1.75P	7003-128A

Hand Knobs



THREAD

Name	Material	Surfaced process
Knob	(KT)	Black
Spindle	Steel (ST)	Zincing (ZI)

ORDER NO. (KT)	THREAD	Knob	CODE NO.
VKB-8K	M8x1.25Px21L	Ø40x65L	7003-133
VKB-8KL	M8x1.25Px63L	Ø40x65L	7003-134A

SPECIAL USAGE MACHINE